



# Buttermilk Crossing

2335 Buttermilk Crossing  
Crescent Springs, KY 41017

**NABergman**



For Lease

1,607 - 5,715 SF | \$18.00 - 20.00 SF/yr

Retail Space



## Buttermilk Crossing

2335 Buttermilk Crossing  
Crescent Springs, Kentucky 41017

### Property Highlights

- Highly trafficked retail center
- Suite 2303 - 1,607 SF (white box)
- Suite 2315 - 4,000 SF (warm grey shell) \*divisible
- Suite 2327 - 5,715 SF (built out medical office w/ MRI) \*divisible
- Rental Rate of \$18 - \$20/SF NNN
- Opportunity for a variety of uses including medical/professional and fitness
- Prominent visibility and easy access to I-71/I-75

For More Information

**Laurence Bergman**

O: 513 322 6307  
larry@bergman-group.com | KY #192679

**Michael Bergman**

O: 513 322 6309  
mbergman@bergman-group.com | OH #BRKM.2020007859

**Gueorgui Chikov**

O: 513 322 6317  
gchikov@bergman-group.com | OH #SAL.2017002265

**Kristina Skurow**

O: 513 322 6308  
kskurow@bergman-group.com | OH #SAL.2023006557



For Lease

1,607 - 5,715 SF | \$18.00 - 20.00 SF/yr

Retail Space



For Lease

1,607 - 5,715 SF | \$18.00 - 20.00 SF/yr

Retail Space

## Available Spaces

Suite	Size (SF)	Lease Type	Lease Rate	Description
Suite 2303	1,607 SF	NNN	\$18.00 SF/yr	White box
Suite 2315	4,000 SF	NNN	\$20.00 SF/yr	Warm grey shell
Suite 2327	2,693 - 5,715 SF	NNN	\$20.00 SF/yr	Built out medical office with MRI

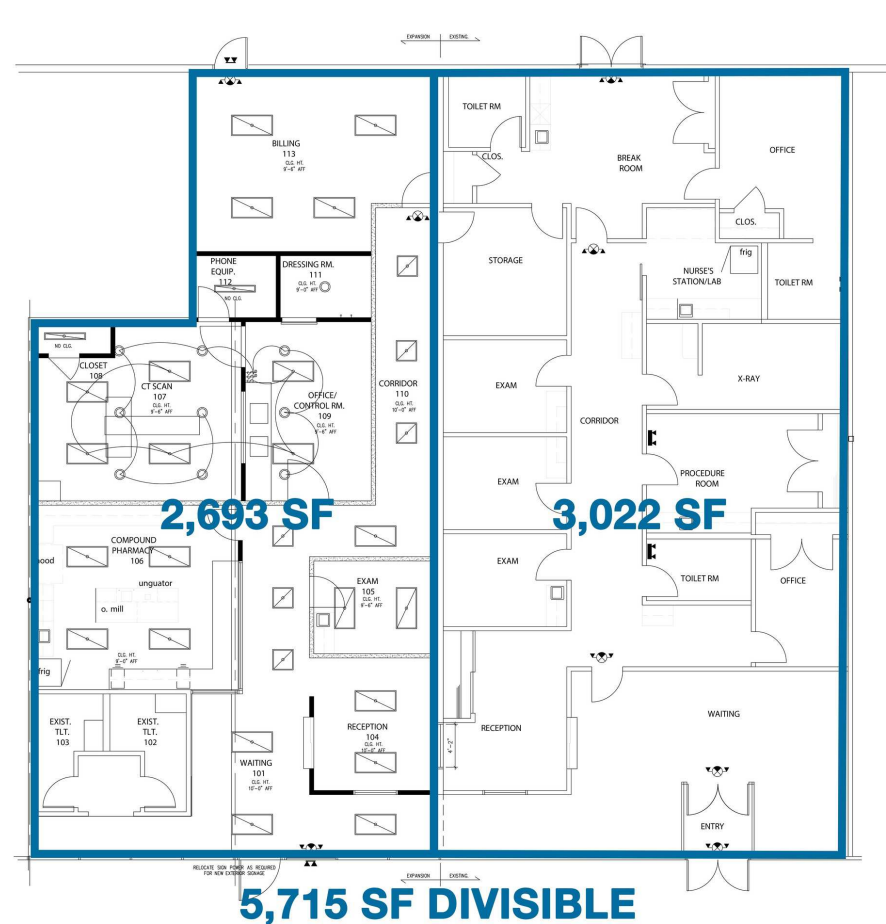

SUITE 2327



For Lease

1,607 - 5,715 SF | \$18.00 - 20.00 SF/yr

Retail Space





For Lease

1,607 - 5,715 SF | \$18.00 - 20.00 SF/yr

Retail Space





For Lease

1,607 - 5,715 SF | \$18.00 - 20.00 SF/yr

Retail Space

Population	1 Mile	3 Miles	5 Miles
Total Population	10,056	56,605	202,430
Average Age	40	41	39
Average Age (Male)	39	40	38
Average Age (Female)	42	42	40
Households & Income	1 Mile	3 Miles	5 Miles
Total Households	4,273	23,590	85,878
# of Persons per HH	2.4	2.4	2.4
Average HH Income	\$114,224	\$109,063	\$86,398
Average House Value	\$405,433	\$328,310	\$265,811

Demographics data derived from AlphaMap

